

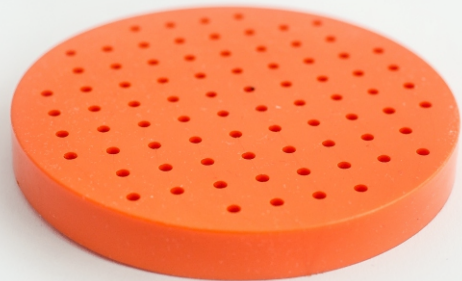

Art. 050

Frezë për shpuarjen e stiropolit
Milling Machine for drilling of Polystyrene
Fräsmaschine für das Bohren von Polystyrol



Art. 051

Rondellë | Rondele | Rundelle



★ ★ ★ ★ ★
PREMIUM QUALITY
ACCORDING TO EUROPEAN
STANDARDS



**INTERNATIONAL PLASTIC
COMPANY**

ADRESA

Rruga Therandë - Rahovec
(R117) Studençan,
23060 Therandë
Kosovë

TELEFON

+381 (0) 29 121 111
+386 (0) 49 506 010
+386 (0) 49 747 030

WEB

info@ipc-plastics.com
www.ipc-plastics.com

ISO 9001

BUREAU VERITAS
Certification

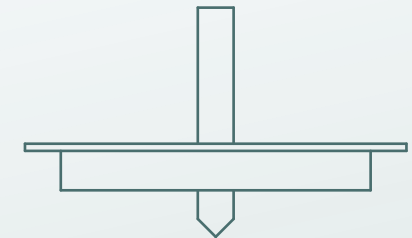
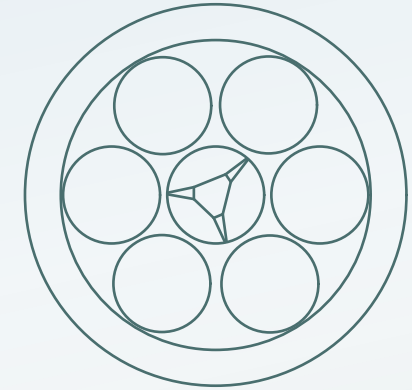

**FREZË PËR
SHPUARJEN
E STIROPOLIT**

MILLING MACHINE FOR DRILLING OF POLYSTYRENE
FRÄSMASCHINE FÜR DAS BOHREN VON POLYSTYROL

&

Rondellë | Rondele | Rundelle

www.ipc-plastics.com

SQ

— Tapë Përforcuese —

Përdoret për përforcim-ankerim stabil të të gjithë aksesoreve që vendosen në fasadë me stiropor dhe stiroduer.

Mënyra e përdorimit: Paraprakisht shpohet vrima në stiropor/stiroduer i cili është i përforcuar në mur. Shpuarja bëhet me frezë nga materiali PVC, pastaj vendoset tapa, mbi të vendosen rrjeta e fasadës, llaqi, fasada.

E certifikuar me standarde Europiane.

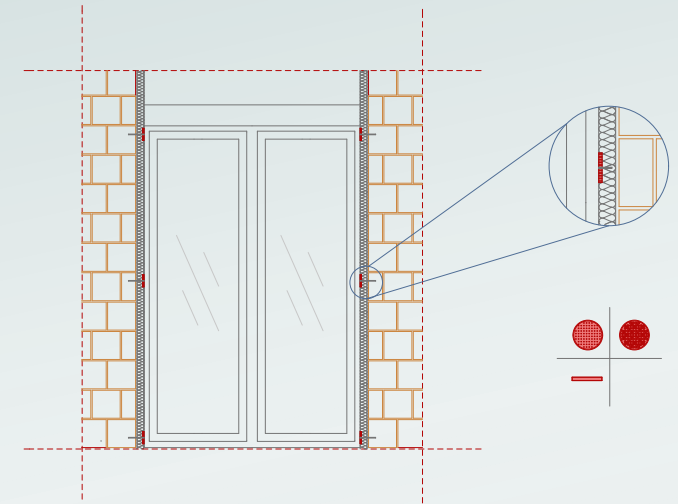
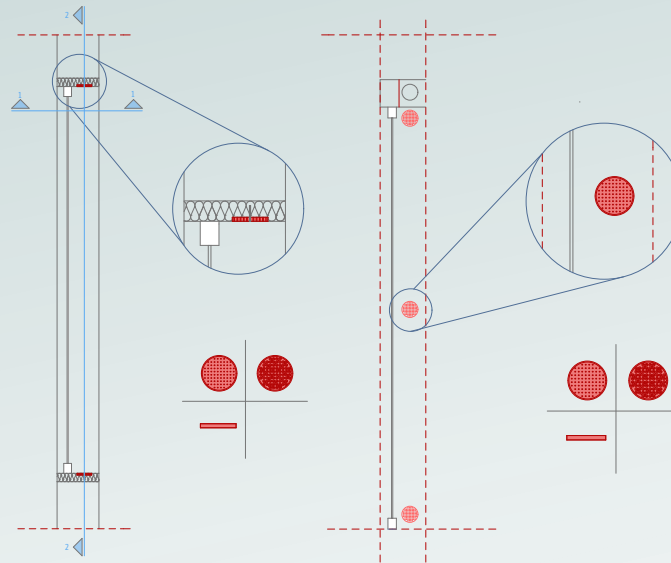

DE

— Bohren von Polystyrol —

Wird zur Verstärkung – stabilen Verankerung aller Zubehörteile benutzt, die bei Styropor- und Styrodurfassaden eingesetzt werden.

Gebrauchsanleitung: Vorab wird ein Loch in den Styropor/Styrodur, der schon an der Wand befestigt wurde, gebohrt. Das Bohren geschieht durch eine Fräsmaschine mit PVC-Material, danach wird der Korken angebracht. Über diesen Korken werden das Netz der Fassade, der Putz und die Fassade angebracht.

Nach europäischem Standard zertifiziert.

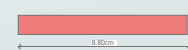
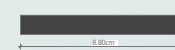
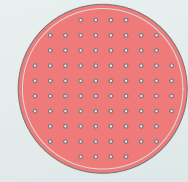
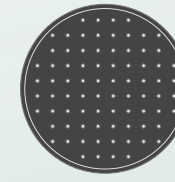
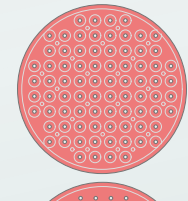
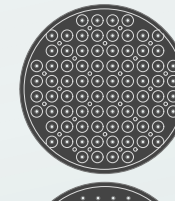
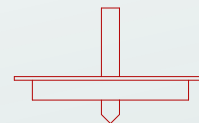
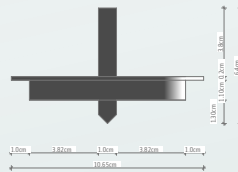
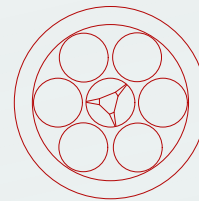
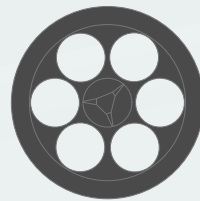

EN

— Polystyrene Drillier —

Used for the reinforcement - stable anchoring of all accessories, which are used in styrofoam and styrofoam. Instructions for use: A hole is drilled in the Styrofoam / Styrodur, which has already been attached to the wall. Drilling is carried out by a milling machine with PVC material, after which the cork is attached. The net of the façade, the plaster and the façade are attached to this cork.

Certified to European standards.

